

## 6216-2Z Deep groove ball

### bearings

- Popular item

- SKF Explorer

### Deep groove ball bearings

#### Bearing data

[Tolerances](#),

Normal (metric), P6, P5, Normal (inch),

[Radial internal clearance](#),

Matched bearing pairs, Stainless steel  
d < 10 mm, Other bearings

#### Bearing interfaces

[Seat tolerances for standard conditions](#),

[Tolerances and resultant fits](#)

## Technical specification

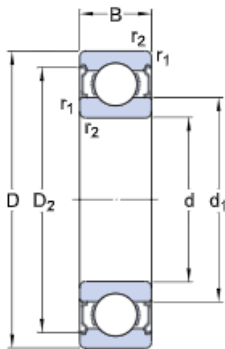

### DIMENSIONS

d	80 mm	Bore diameter
D	140 mm	Outside diameter
B	26 mm	Width
d <sub>1</sub>	≈ 101.4 mm	Shoulder diameter
D <sub>2</sub>	≈ 126.5 mm	Recess diameter
r <sub>1,2</sub>	min. 2 mm	Chamfer dimension

### ABUTMENT DIMENSIONS

d <sub>c</sub> min.	91 mm	Diameter of shaft abutment
d <sub>c</sub> max.	100.9 mm	Diameter of shaft abutment
D <sub>i</sub> max.	129 mm	Diameter of housing abutment
r <sub>a</sub> max.	2 mm	Radius of shaft or housing fillet

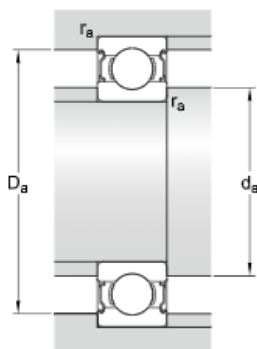

## CALCULATION DATA

C	72.8 kN	Basic dynamic load rating
C <sub>0</sub>	55 kN	Basic static load rating
P <sub>u</sub>	2.2 kN	Fatigue load limit
	9 500 r/min	Reference speed
	4 800 r/min	Limiting speed
k <sub>r</sub>	0.025	Minimum load factor
f <sub>0</sub>	15	Calculation factor

## MASS

	1.53 kg	Mass bearing
--	---------	--------------

## TOLERANCE CLASS

P6	Dimensional tolerances
Normal	Radial run-out